

**CONCRETE SIDEWALK SECTION  
(5' WIDTH)  
NOT TO SCALE**

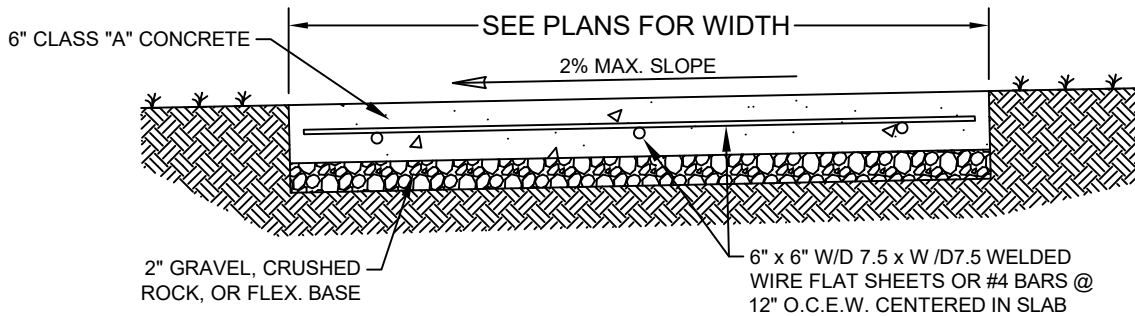

**CONCRETE SIDEWALK SECTION  
(6'-10' WIDTH)  
NOT TO SCALE**

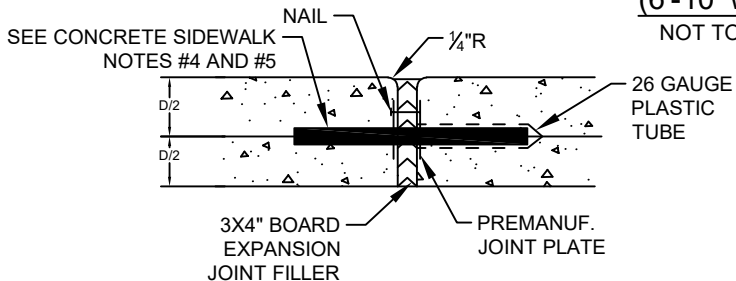

**DOWEL TYPICAL EXPANSION JOINT  
NOT TO SCALE**

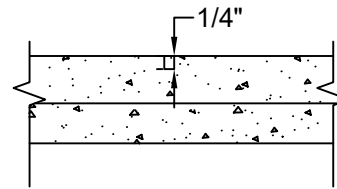

**CONCRETE SIDEWALK CONTROL JOINT  
NOT TO SCALE**

**SIDEWALK EXPANSION JOINT NOTES:**

1. STEEL TO MEET ASTM STD SPECIFICATIONS FOR CONC. REINFOR. BARS.
2. EXPANSION JOINT TO BE PLACED AT THE END OF EACH CURB RADIUS AND SPACED AT A DISTANCE OF 60 FEET (MAXIMUM 75 FEET). MAXIMUM SPACING FOR CONTROL JOINTS SHALL BE 10 FEET (MAXIMUM 15 FEET).
3. CENTER DOWEL HORIZONTALLY ON JOINT.
4. CENTER DOWEL VERTICALLY IN CONCRETE AS NEEDED TO MAINTAIN 2" COVER.
5. SAWING OF CONTROL JOINTS SHALL BEGIN AS SOON AS CONCRETE WILL NOT RAVEL.
6. ALL LONGITUDINAL AND TRANSVERSE CONSTRUCTION JOINTS SHALL BE DOWELED TO PROMOTE LOAD TRANSFER.
7. EXPANSION JOINT MATERIAL SHALL BE FULL SLAB DEPTH, BITUMINOUS FIBER BOARD.
8. ALL EXPANSION JOINTS, CONSTRUCTION JOINTS, AND CONTROL JOINTS TO HAVE BACKER ROD AND ELASTOMERIC JOINT SEALANT MATERIAL APPLIED. ALL JOINTS SHALL BE CLEANED AS RECOMMENDED BY SEALANT MANUFACTURER.
9. CONSTRUCTION, EXPANSION, AND CONTROL JOINTS SHALL BE LAID OUT TO FORM SQUARE PANELS WHERE PRACTICAL BUT NOT TO EXCEED A.C.I. 302.69 CODE RECOMMENDATIONS.
10. NO EXPANSION OR CONSTRUCTION JOINT SHALL BE LOCATED IN SWALES OR DRAINAGE COLLECTION LOCATIONS.
11. NO STEEL REINFORCEMENT SHALL EXTEND ACROSS EXPANSION JOINTS.

**CONCRETE SIDEWALK NOTES:**

1. SIDEWALK SHALL HAVE A MINIMUM WIDTH OF 5' AND BE LOCATED A MINIMUM OF 2' FROM THE BACK OF CURB.
2. DUMMY JOINTS PARALLEL TO THE CURB SHALL BE PLACED WHERE THE SIDEWALK MEETS THE DRIVEWAY.
3. DUMMY JOINTS PERPENDICULAR TO THE CURB, AND WITHIN THE BOUNDARIES OF THE PARALLEL DUMMY JOINTS, SHALL BE PLACED AT INTERVALS EQUAL TO THE WIDTH OF THE SIDEWALK.
4. A MINIMUM OF TWO ROUND AND SMOOTH DOWEL BARS 3/8" IN DIAMETER AND 18" IN LENGTH SHALL BE SPACED 18" APART AT EACH EXPANSION JOINT FOR CONCRETE SIDEWALK PAVEMENT THICKNESS OF 4 INCHES.
5. A MINIMUM OF TWO ROUND AND SMOOTH DOWEL BARS 3/4" IN DIAMETER AND 18" IN LENGTH SHALL BE SPACED 18" APART AT EACH EXPANSION JOINT FOR CONCRETE SIDEWALK PAVEMENT THICKNESS OF 6 INCHES.
6. SIDEWALK RAMP LENGTHS SHALL BE OF SUFFICIENT LENGTH TO MAINTAIN 8.33% (1:12) MAXIMUM SLOPE. WHERE SIDEWALKS CROSS DRIVEWAYS, SIDEWALK CROSS SLOPE SHALL NOT EXCEED 2%.
7. SIDEWALK RAMP SURFACE SHALL BE BRUSH FINISHED.
8. CURB SHALL BE TAPERED TO FINISH FLUSH WITH SIDEWALK.